



## Capacity from 3 kg to 50 kg



- ALUMINUM ALLOY
- COMBINED ERROR  $\leq \pm 0.02\%$  (0.017% C4; 0.014% C5)
- IP65 PROTECTION RATING

CAPACITY	kg	ACCURACY CLASS					PLATFORM (mm)	NET WEIGHT (kg)
		C3	C4	C5				
3		•	•	•	•	•	250 x 350	0.2
5		•	•	•	•	•	250 x 350	0.2
10		•	•	•	•	•	250 x 350	0.2
15		•	•	•	•	•	250 x 350	0.2
20		•	•	•	•	•	250 x 350	0.2
30		•	•	•	•	•	250 x 350	0.2
50		•	•	•	•	•	250 x 350	0.2

ON REQUEST

## CERTIFICATIONS

- OIML R60 C3
- Complies with the Eurasian Customs Union regulations
- Equivalent of the CE marking for the United Kingdom
- Complies with United Kingdom regulations for legal for trade use

## CERTIFICATIONS ON REQUEST

	Calibration report
	ATEX II 1G 2D (zone 0-1-2-21-22) (CE - UK CA)
	IECEx (zone 0-1-2-20-21-22)
	OIML R60 C4/C5
	Complies with the Eurasian Customs Union regulations for use in potentially explosive atmospheres
	Complies with Chinese market regulations for use in potentially explosive atmospheres
	NTEP - Complies with United States regulations for legal for trade use

## COMPLEMENTARY ACCESSORIES

DESCRIPTION	
<p>Pair of stainless steel tension brackets. Maximum static load: 50 kg.</p>	STAFFEALL

### DIMENSIONS (mm)

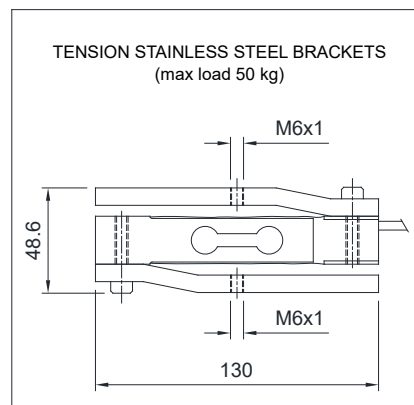
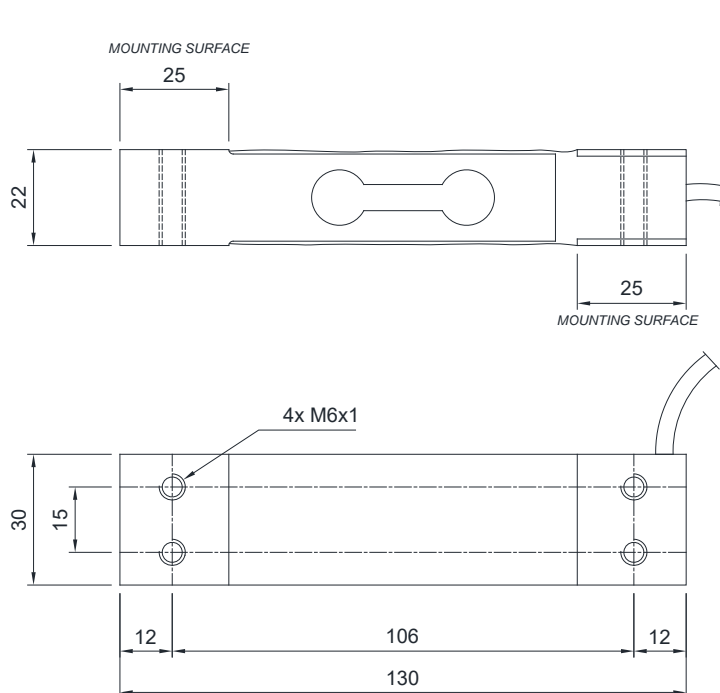

For the load cell fixing screws, provide the tightening torque indicated in the table

Screw	M6	
Screw class	6.8	8.8
Tightening torque	7.5 Nm	10 Nm

### TECHNICAL FEATURES

Material	Aluminum alloy		
OIML R60 Accuracy class • Verification intervals	C3 • 3000	C4 • 4000	C5 • 5000
Nominal load (E max)	3 - 5 - 10 - 15 - 20 - 30 - 50 kg		
Minimum verification interval (V min)	E max / 10000	E max / 15000	E max / 20000
Combined error	≤ ±0.02%	≤ ±0.017%	≤ ±0.014%
Protection rating	IP65		
Rated output	2 mV/V ± 10%	Input resistance	409 Ω ± 6
Temperature effect on zero	0.0017% °C	Output resistance	350 Ω ± 3
Temperature effect on span	0.0014% °C	Zero balance	≤ ±2%
Compensated temperature range	-10 °C / +40 °C	Insulation resistance	≥ 5000 MΩ
Operating temperature range	-35 °C / +65 °C	Safe overload (% of full scale)	150%
Creep at nominal load in 30 minutes	0.015%	Ultimate overload (% of full scale)	300%
Max supply voltage without damage	18 V	Deflection at nominal load	0.5 mm

### ELECTRICAL CONNECTIONS

Cable length	3 m
Cable diameter	3.8 mm
Cores	4 x 0.20 mm²



SHIELD	
+ SIGNAL	GREEN
+ EXCITATION	RED
- SIGNAL	WHITE
- EXCITATION	BLACK