





### Capacity up to 3000 kg

- AISI 304 stainless steel platform with tipper loading plate.
- 4 load cells FT-P 500 kg or FT-P 1000 kg  
17-4 PH stainless steel - IP68 (on request: IP69K).
- IP67 stainless steel junction box with equalization board and 6-wire output cable (length: 5 m).
- AISI 304 stainless steel adjustable feet, self-centering on sphere.
- 4 lifting lugs.



CAPACITY	kg	ACCURACY CLASS C3	 	DIMENSION (mm)	WEIGHT (kg)	CODE
600		•	•	800 x 800	68	PO800I600
600		•	•	1000 x 1000	87	PO1000I600
1500		•	•	1000 x 1000	87	PO1000I1500
1500		•	•	1250 x 1250	127	PO1250I1500
1500		•	•	1500 x 1500	167	PO1500I1500
3000		•	•	1250 x 1250	127	PO1250I3000
3000		•	•	1500 x 1500	167	PO1500I3000

   
ON REQUEST

### CERTIFICATIONS



OIML R60 C3



Equivalent of the CE marking for the United Kingdom

#### CERTIFICATIONS ON REQUEST



IP69K

Declaration of conformity + IP69K marking protection rating

Water protection in case of high-pressure or steam jet cleaning (test: pressurized water is sprayed from a distance of max 150 mm)  
Water pressure: 100 bar; temperature: 80 °C; test duration: 250 seconds (reference standard: DIN 40050-9)



ATEX II 2GD (zone 1-2-21-22)



IECEx (zone 1-2-21-22)

### DIMENSIONS (mm)

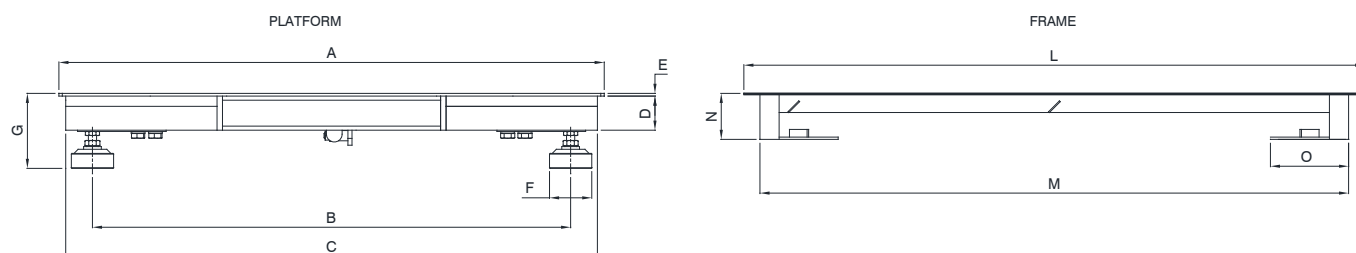



Code	Platform capacity	A	B	C	D	E	F	G
PO800I600	600 kg	800 x 800	660 x 662	780 x 760	50	5	60	90÷110
PO1000I600	600 kg	1000 x 1000	860 x 862	980 x 960	50	5	60	90÷110
PO1000I1500	1500 kg	1000 x 1000	860 x 862	980 x 960	50	5	60	90÷110
PO1250I1500	1500 kg	1250 x 1250	1110 x 1112	1230 x 1210	50	5	60	90÷110
PO1250I3000	3000 kg	1250 x 1250	1110 x 1112	1230 x 1210	50	6	60	90÷110
PO1500I1500	1500 kg	1500 x 1500	1360 x 1362	1480 x 1460	50	5	60	90÷110
PO1500I3000	3000 kg	1500 x 1500	1360 x 1362	1480 x 1460	50	6	60	90÷110

Code	L	M	N	O	Gross weight
TLP800INOXN	916 x 916	822 x 822	110	200	30 kg
TLP1000INOXN	1116 x 1116	1022 x 1022	110	200	33 kg
TLP1250INOXN	1366 x 1366	1272 x 1272	110	200	33 kg
TLP1500INOXN	1616 x 1616	1522 x 1522	110	200	36 kg

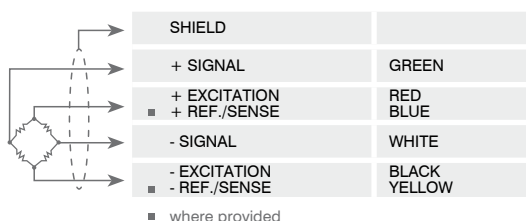
### ELECTRICAL CONNECTIONS



### OPTIONS ON REQUEST

DESCRIPTION	CODE
 <p>AISI 304 stainless steel pit frame with centering plates. For platforms:</p> <p>800x800 mm</p> <p>1000x1000 mm</p> <p>1250x1250 mm</p> <p>1500x1500 mm</p>	<p>TLP800INOXN</p> <p>TLP1000INOXN</p> <p>TLP1250INOXN</p> <p>TLP1500INOXN</p>
 <p>Stainless steel indicator-holder column (Ø38 mm, height 700 mm). Stainless steel bracket for floor mounting.</p>	<p>COLONNAM + STAFFAIN</p>

The Company reserves the right to make changes to the technical data, drawings and images without notice.